



Compass Caravans
a division of Australian Hitec Engineering Pty Ltd
ABN 54 068 824 984

4-6 Lisa Place,
Coolaroo, Vic 3048
Tel: 9301 8700
Fax: 9302 3722
Email: sales@compasscaravans.com.au



LIMITED EDITION VAN SPECIFICATIONS

(SIMILAR TO AURORA MODEL SPECIFICATIONS WITH THE FOLLOWING ADD./VARIATIONS)

INTERNAL

CEILING DOWN LIGHTS

STOVE OVEN WITH ONE ELECTRIC ELEMENT (NOT FAN FORCED & NO WOK BURNER)

DOMETIC CHINA BOWL TOILET (APPLICABLE TO 19' MODEL)

SLIDING DOOR TO ENSUITE (APPLICABLE TO 19' MODEL)

EXTERNAL

ROUND BOTTOM SHAPE AT FRONT OF VAN

TUNNEL BOOT

8" JOCKEY WHEEL

1/2 CHEQUER PLATE FRONT (TO BOTTOM OF BOOT LID WITH VINYL EACH SIDE OF BOOT)

CHEQUER PLATE SIDES

PICNIC TABLE

ROH STEEL WHEELS (NOT ALLOY)

EXTERNAL GRAB HANDLE (NOT ILLUMINATED)

*** EXTRA OPTIONS AVAILABLE (REFER TO ORDER FORM)**

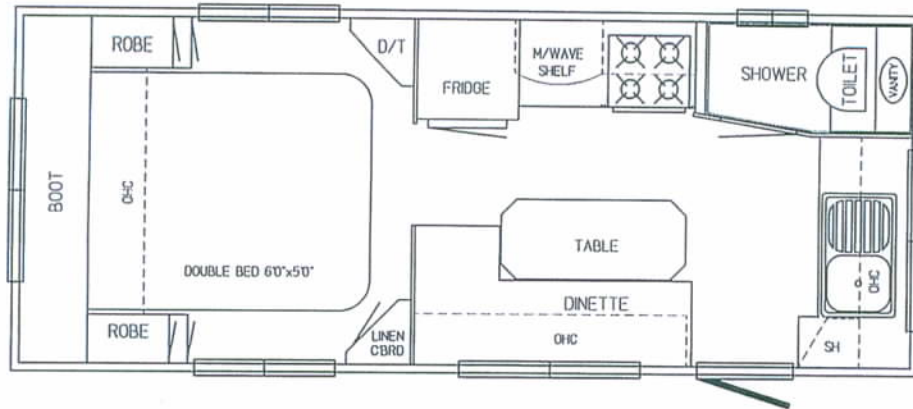

17'6"x7'6"-8 SH RD LIMITED EDITION

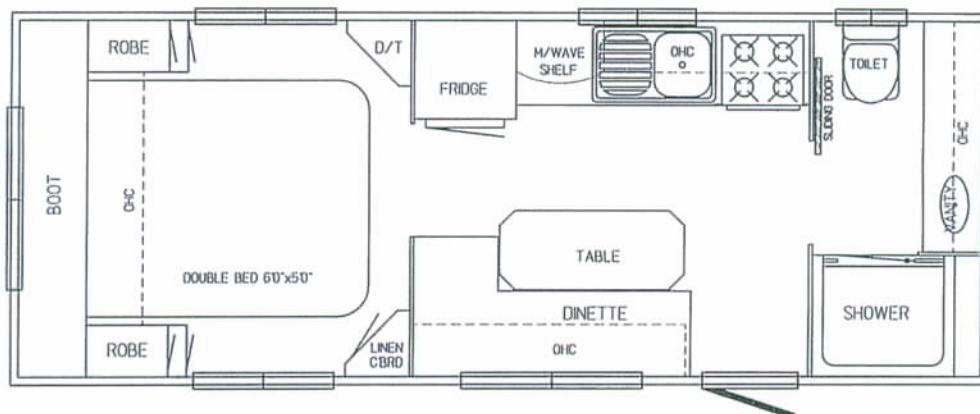

19'0"x7'10"-5 SH RD LIMITED EDITION